

Key West II

Artisan Series

3,129-3,481 Square Feet | 3-4 Bedrooms

2-4 Baths | 3-Car Garage



Mediterranean A | FMD12



Tuscan A | TUS5



Modern | MOD3



Modern Farmhouse | MFH6



Coastal C | COA1



[homesbywestbay.com](https://www.homesbywestbay.com)

*FRONT WINDOWS, ENTRY/PORCHES AND ROOM DIMENSIONS MAY VARY PER ELEVATION
*REFERENCE MASTER PLAN SETS FOR ACTUAL SQUARE FOOTAGE TOTALS AND ENTRY LAYOUTS

*Artist's conceptual rendering. Actual construction may vary in color, features and dimensions. Availability, specifications, and pricing are subject to change without notice. All plans require developer approval and may be modified in order to comply with these developer requirements. Please speak with a Homes by West Bay Community Sales Manager for current information and about options where available. © 2025 Homes by West Bay LLC, CRC #057247. All rights reserved. Not an offer to purchase where prohibited by law. Broker Participation Welcome. 082724

SF50



Artisan Series

4,250-4,619 Square Feet | 4-6 Bedrooms

2-4 Baths | 3-Car Garage

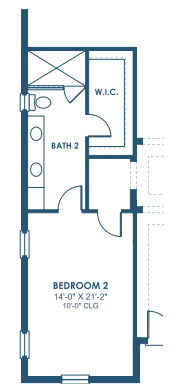

OPT. BEDROOM 2 SUITE

OPT. BEDROOM 5
W/ WET BAR

OPT. BEDROOM 5

OPT. MEDIA ROOM

SECOND FLOOR

OPT. BONUS ROOM W/
GUEST SUITE AND BATH 6

OPT. DEN 3

OPT. SHOWER
ILO TUB AT BATH 2

OPT. SUITE 2

OPT. DEN 2

OPT. BONUS ROOM

OPT. BEDROOM 6

MAIN FLOOR

OPT. O.D.K. PREP
FOR FUTURE O.D.K.

OPT. POOL BATH

OPT. STARGAZE
RELAXATION M. BATH

OPT. M. BATH W/
DELUXE SHOWER

*FRONT WINDOWS, ENTRY/PORCHES AND ROOM DIMENSIONS MAY VARY PER ELEVATION

*REFERENCE MASTER PLAN SETS FOR ACTUAL SQUARE FOOTAGE TOTALS AND ENTRY LAYOUTS

*Artist's conceptual rendering. Actual construction may vary in color, features and dimensions. Availability, specifications, and pricing are subject to change without notice. All plans require developer approval and may be modified in order to comply with these developer requirements. Please speak with a Homes by WestBay Community Sales Manager for current information and about options where available. © 2025 Homes by West Bay LLC, CRC #057247. All rights reserved. Not an offer to purchase where prohibited by law. Broker Participation Welcome. 082724

SF50