

# Biscayne I

Artisan Series

2,562-2,705 Sq.Ft. | 3-4 Bedrooms  
3-4 Baths | 3-Car Garage



Mediterranean B | FMD1



European B | EUC2



Tuscan A | TUS5

# Biscayne I

## Artisan Series

2,562-2,705 Sq.Ft. | 3-4 Bedrooms  
3-4 Baths | 3-Car Garage

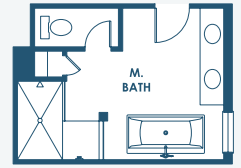
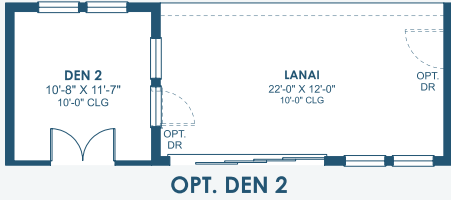
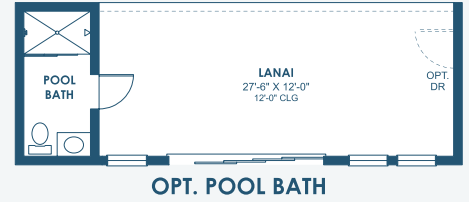
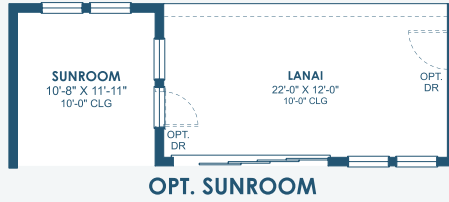
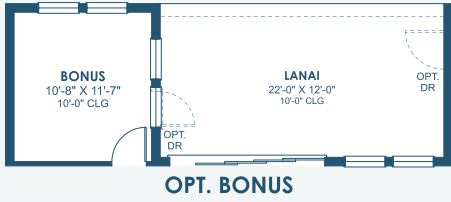

**OPT. STARGAZE RELAXATION MASTER BATHROOM**

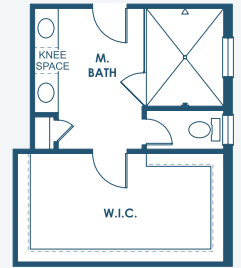

**OPT. DELUXE SHOWER AT MASTER BATHROOM**



**OPT. OWNER'S W.I.C.**

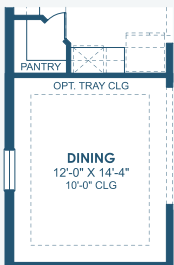
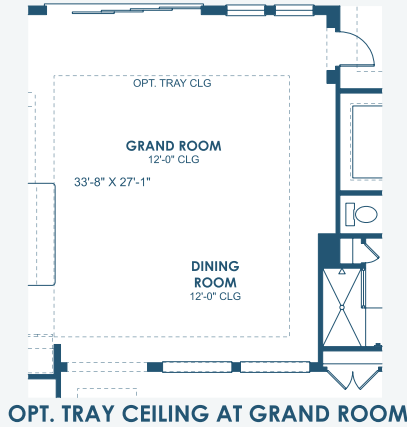

**OPT. DINING**

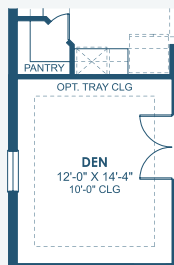

**OPT. DEN**

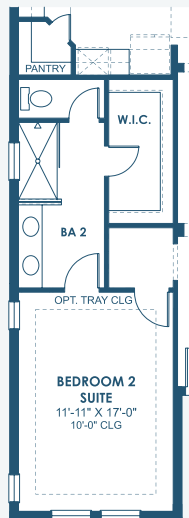

**OPT. BEDROOM 2 SUITE**