

Biscayne II

Artisan Series

3,138-3,281 Sq.Ft. | 4-5 Bedrooms
4-5 Baths | 3-Car Garage



Mediterranean B | FMD9



Tuscan A | TUS9



Tuscan B | TUS4



Coastal C | COA5



Modern | MOD3



Modern Farmhouse | MFH2

Biscayne II

Artisan Series

3,138-3,281 Sq.Ft. | 4-5 Bedrooms
4-5 Baths | 3-Car Garage

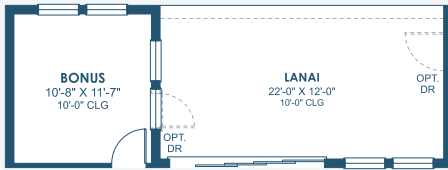

OPT. BONUS

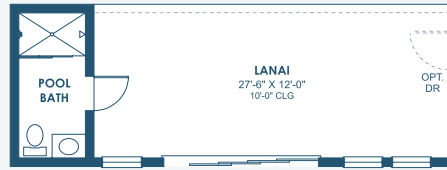

OPT. POOL BATH

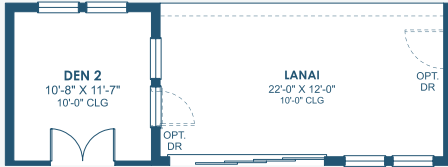

OPT. DEN 2

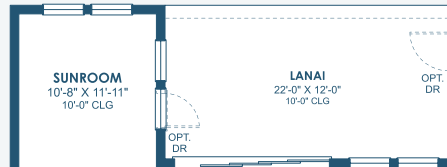

OPT. SUNROOM

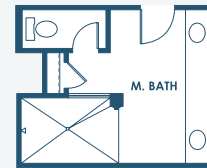

OPT. DELUXE SHOWER AT
MASTER BATHROOM

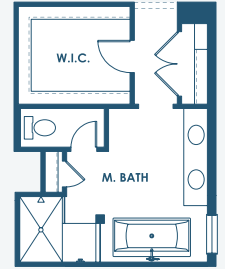

OPT. STARGAZE
RELAXATION
MASTER BATHROOM

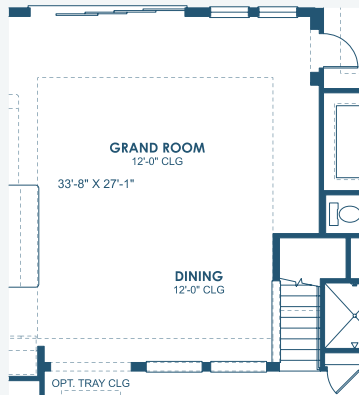

OPT. TRAY CEILING AT GRAND ROOM

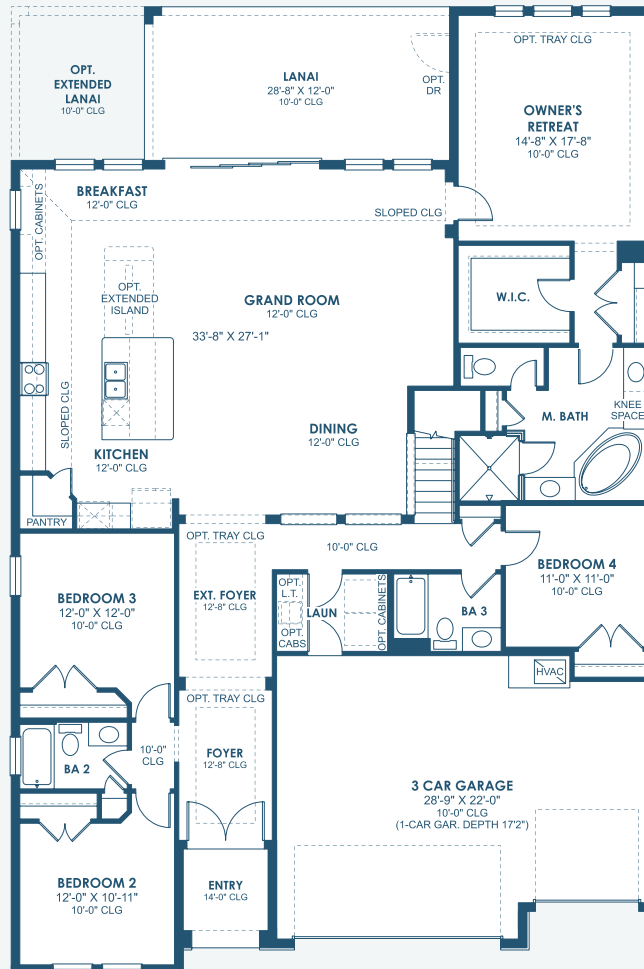

MAIN FLOOR



OPT. OWNER'S W.I.C.

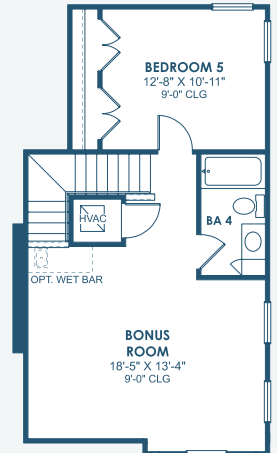

SECOND FLOOR

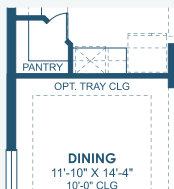

OPT. DINING

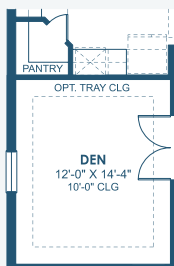

OPT. DEN

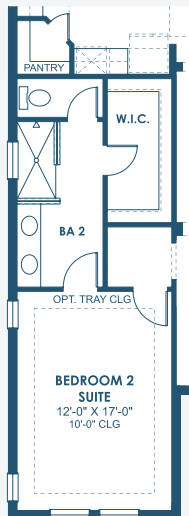

OPT. BEDROOM 2 SUITE