

Biscayne II

Artisan Series

3,138-3,281 Sq.Ft. | 4-5 Bedrooms
4-5 Baths | 3-Car Garage



Mediterranean B | FMD2



European B | EUC6



Tuscan A | TUS2

Biscayne II

Artisan Series

3,138-3,281 Sq.Ft. | 4-5 Bedrooms
4-5 Baths | 3-Car Garage

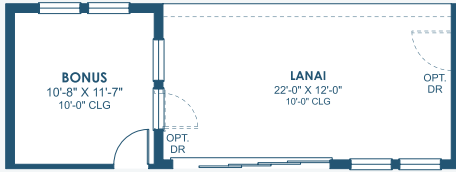

OPT. BONUS

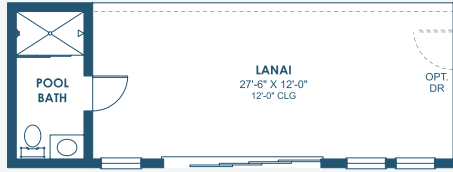

OPT. POOL BATH

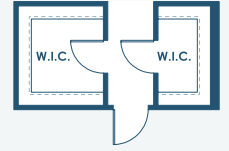

OPT. OWNER'S W.I.C.

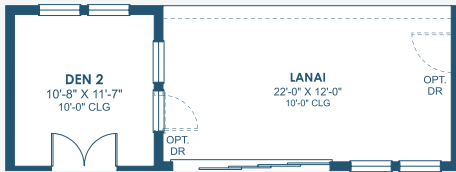

OPT. DEN 2



OPT. SUNROOM

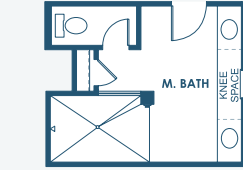

OPT. DELUXE SHOWER AT MASTER BATHROOM

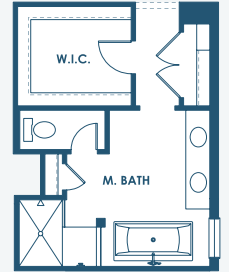

OPT. STARGAZE RELAXATION MASTER BATHROOM

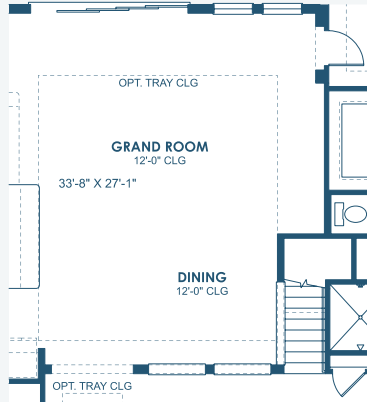

OPT. TRAY CEILING AT GRAND ROOM

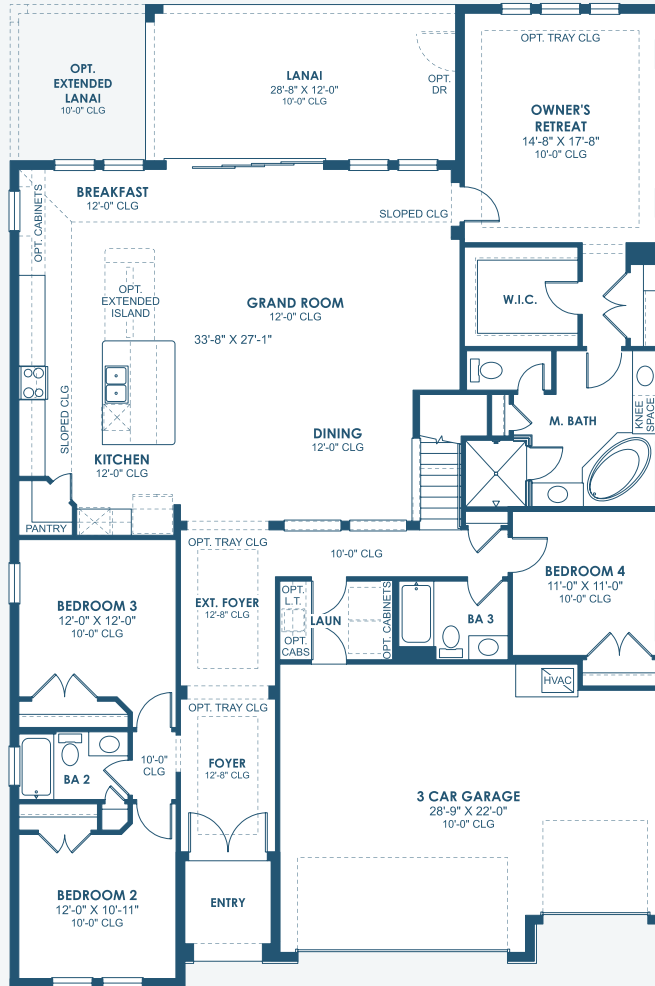

MAIN FLOOR

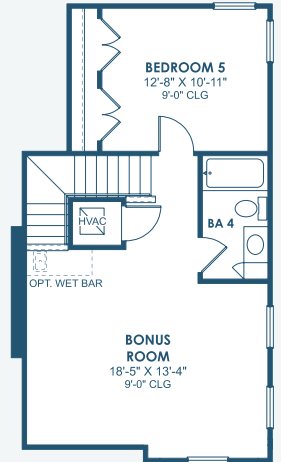

SECOND FLOOR

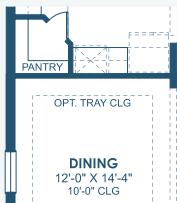

OPT. DINING

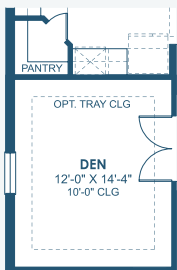

OPT. DEN

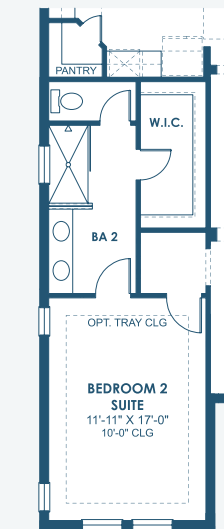

OPT. BEDROOM 2 SUITE