

# Biscayne II

Artisan Series

3,138-3,281 Sq.Ft. | 4-5 Bedrooms  
4-5 Baths | 3-Car Garage



Mediterranean B | FMD2



European B | EUC6



Tuscan A | TUS2



Coastal A | COA1



Coastal B | COA4



Coastal C | COA5

# Biscayne II

## Artisan Series

3,138-3,281 Sq.Ft. | 4-5 Bedrooms  
4-5 Baths | 3-Car Garage

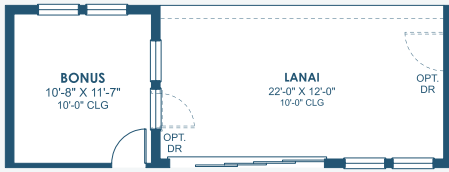

OPT. BONUS

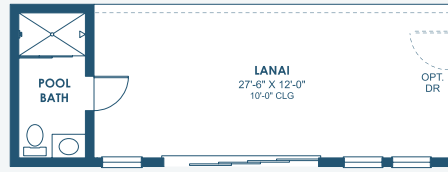

OPT. POOL BATH

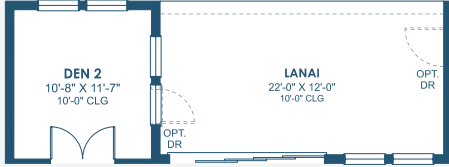

OPT. DEN 2

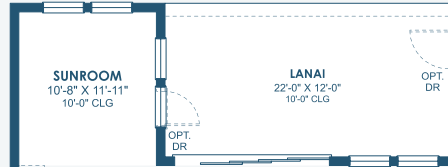

OPT. SUNROOM

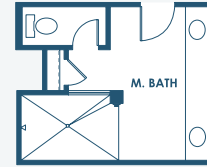

OPT. DELUXE SHOWER AT MASTER BATHROOM

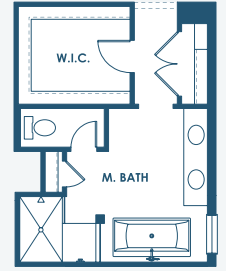

OPT. STARGAZE RELAXATION MASTER BATHROOM

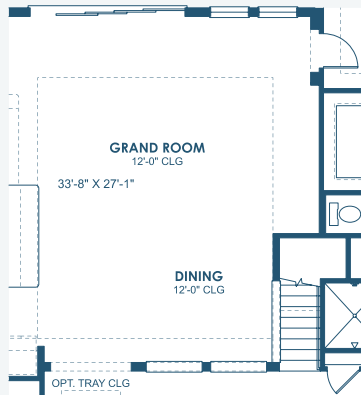

OPT. TRAY CEILING AT GRAND ROOM



MAIN FLOOR

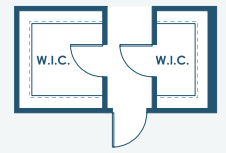

OPT. OWNER'S W.I.C.

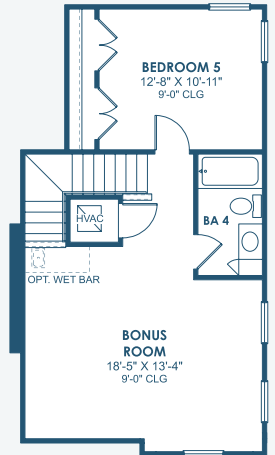

SECOND FLOOR

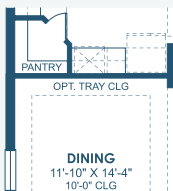

OPT. DINING

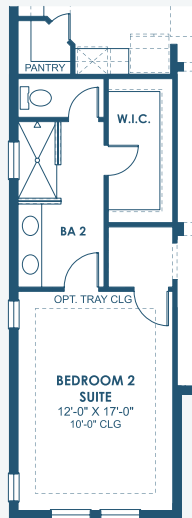

OPT. BEDROOM 2 SUITE

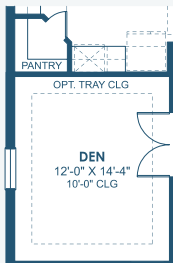

OPT. DEN

\*FRONT WINDOWS, ENTRY/PORCHES AND ROOM DIMENSIONS MAY VARY PER ELEVATION\*  
\*REFERENCE MASTER PLAN SETS FOR ACTUAL SQUARE FOOTAGE TOTALS AND ENTRY LAYOUTS\*

\*Artist's conceptual rendering. Actual construction may vary in color, features and dimensions. Availability, specifications, and pricing are subject to change without notice. All plans require developer approval and may be modified in order to comply with these developer requirements. Please speak with a Homes by WestBay Community Sales Manager for current information and about options where available. © 2025 Homes by West Bay LLC, CRC #057247. All rights reserved. Not an offer to purchase where prohibited by law. Broker Participation Welcome. 012225