

# Key West II

Artisan Series

4,250-4,619 Sq.Ft. | 4-6 Bedrooms  
3-5 Baths | 3-Car Garage



Mediterranean A | FMD10



Craftsman A | CRT3



European A | EUC2



Tuscan A | TUS5

# Key West II

## Artisan Series

4,250-4,619 Sq.Ft. | 4-6 Bedrooms  
3-5 Baths | 3-Car Garage

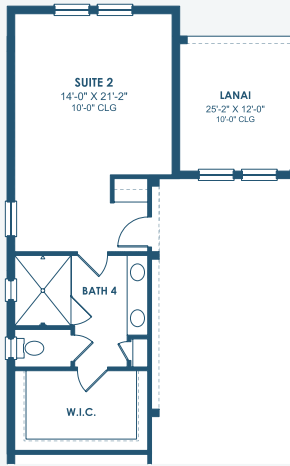

OPT. 2ND MASTER SUITE

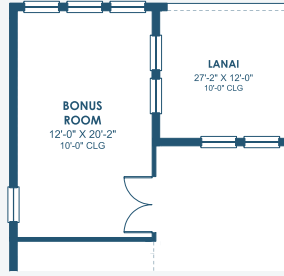

OPT. BONUS ROOM

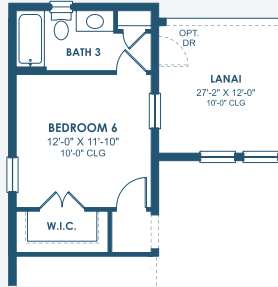

OPT. BEDROOM 6

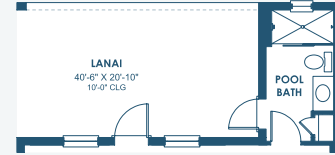

OPT. POOL BATH

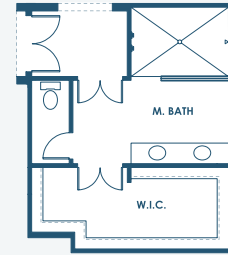

OPT. M. BATH W/  
DELUXE SHOWER

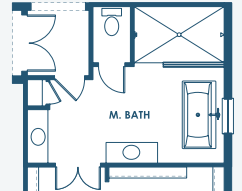

OPT. STARGAZE  
RELAXATION M. BATH

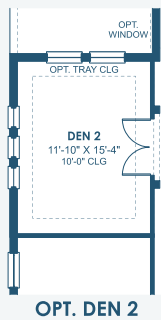

OPT. DEN 2

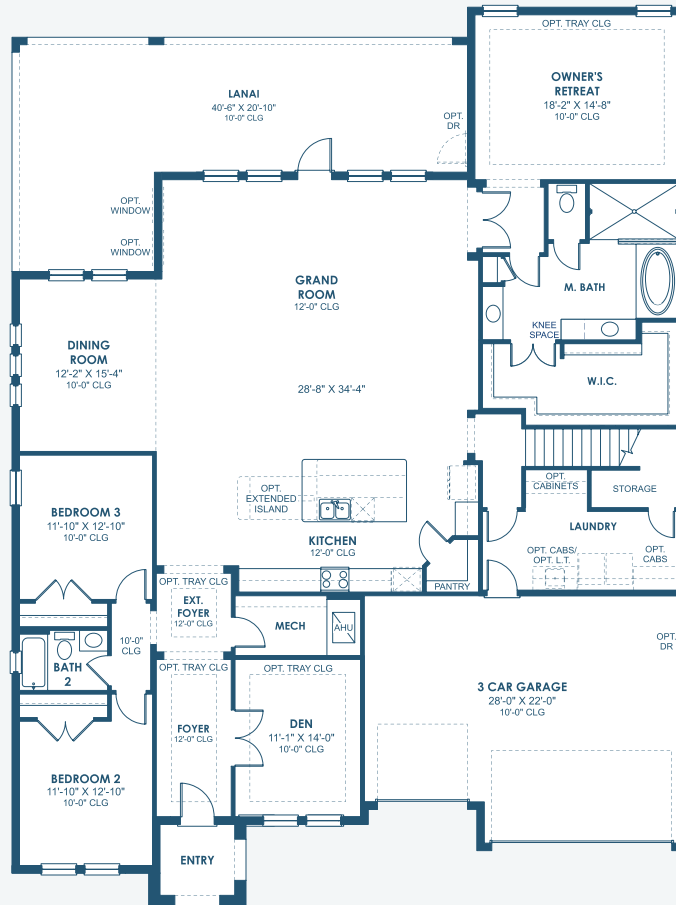

MAIN FLOOR

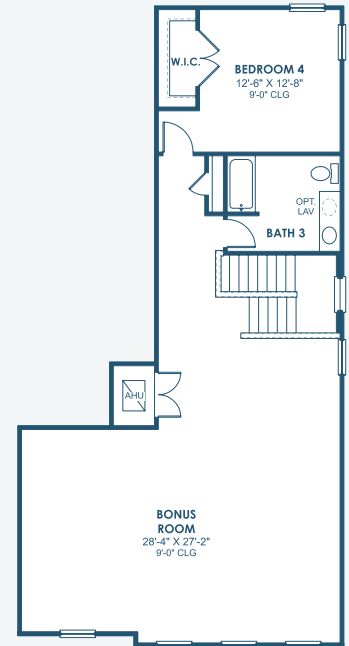

SECOND FLOOR

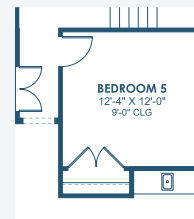

OPT. BEDROOM 5  
W/ WET BAR

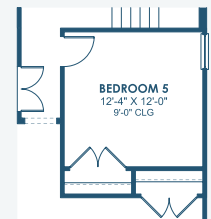

OPT. BEDROOM 5