

Biscayne I

Artisan Series

2,562–2,705 Sq.Ft. | 3–4 Bedrooms
3–4 Baths | 3–Car Garage



Mediterranean B | FMD1



European B | EUC2



Tuscan A | TUS5



Coastal 1 | COA4



Coastal 2 | COA8



Coastal 3 | COA3

Biscayne I

Artisan Series

2,562-2,705 Sq.Ft. | 3-4 Bedrooms
3-4 Baths | 3-Car Garage

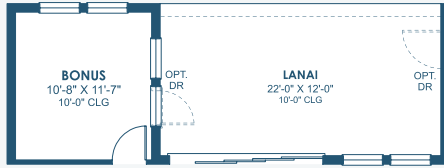

OPT. BONUS

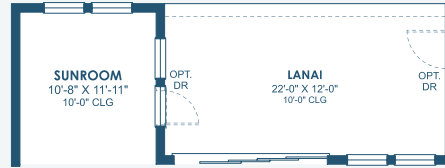

OPT. SUNROOM

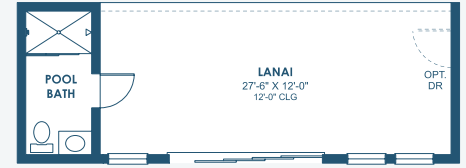

OPT. POOL BATH

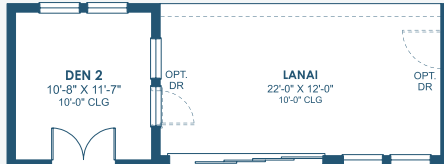

OPT. DEN 2

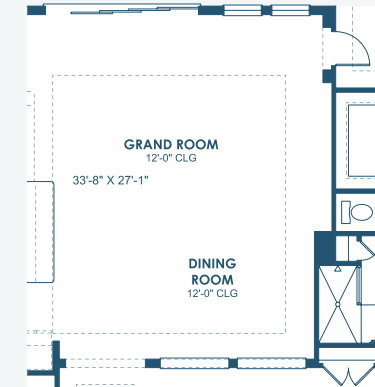

OPT. TRAY CEILING AT GRAND ROOM

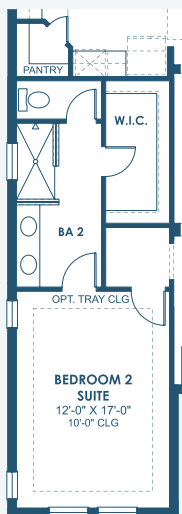

OPT. BEDROOM 2 SUITE

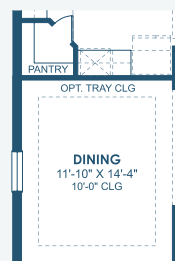

OPT. DINING

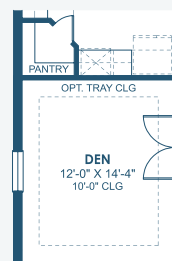

OPT. DEN

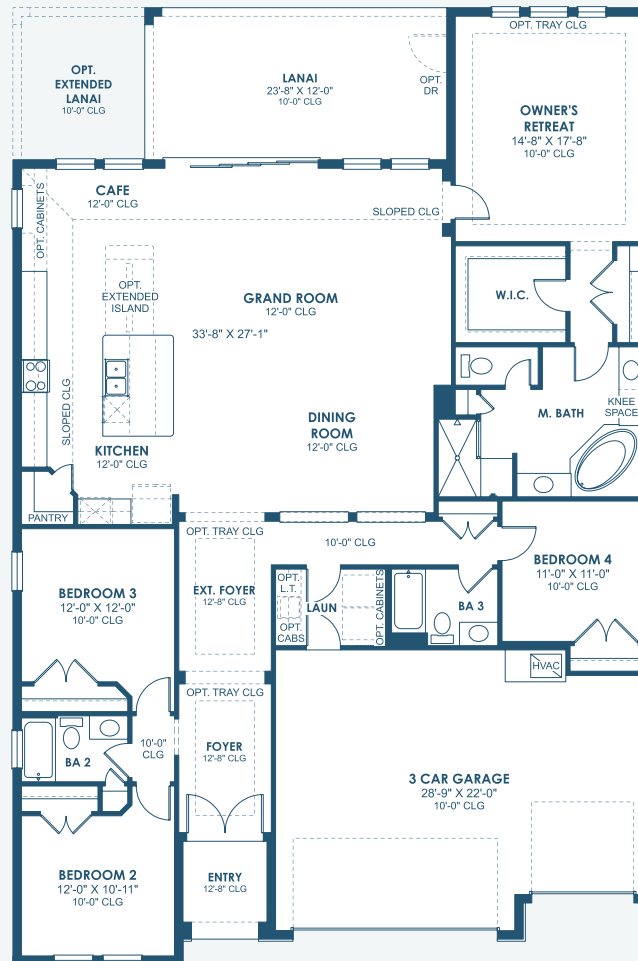

MAIN FLOOR

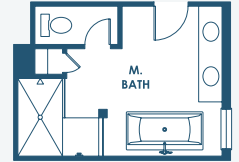

OPT. STARGAZE RELAXATION MASTER BATHROOM

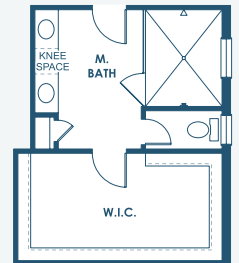

OPT. DELUXE SHOWER AT MASTER BATHROOM

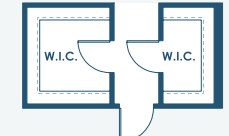

OPT. OWNER'S W.I.C.